

To Insert Strap:

Press button on inside of glasses to release arms. Insert strap into opening and “click” into place.

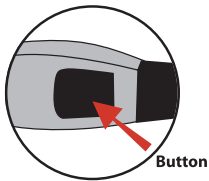

To Remove Strap:

Press on the same button to release the strap, then replace the sunglasses arms.

Inserting or Removing Foam Eye Pad:

1



Align the two tabson each end of the foam with the two slits on either side of the frame.

2

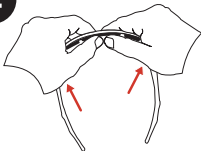

Push the foam into the slits on frame until secure.